

Phase 1

Full closure as per traffic
management plan

**Wednesday 1st October -
Friday 17th October**

Symbolised diversion via A4169,
A5223 and Wellington Road

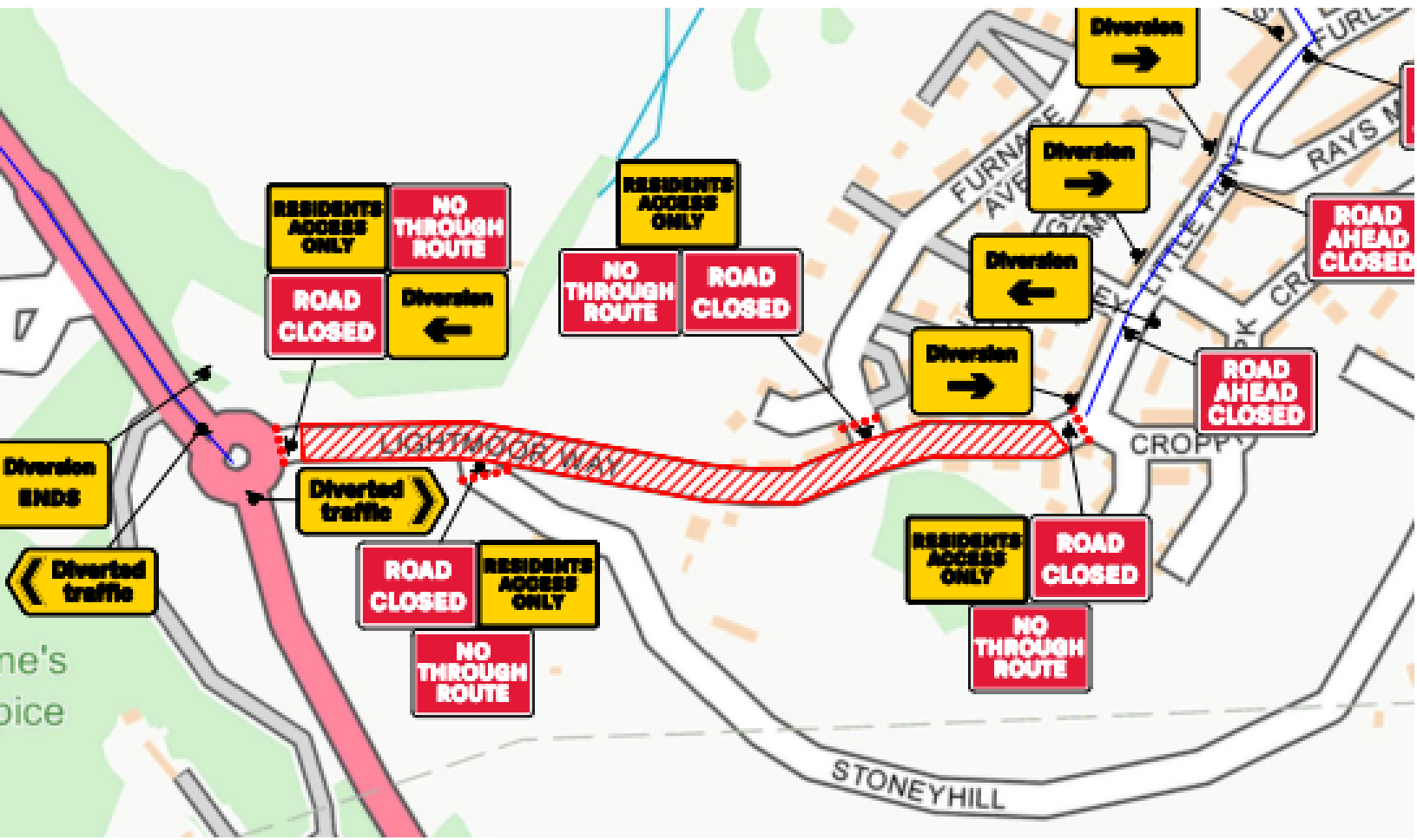

Bus diversion via Croppings Park with on street parking suspended

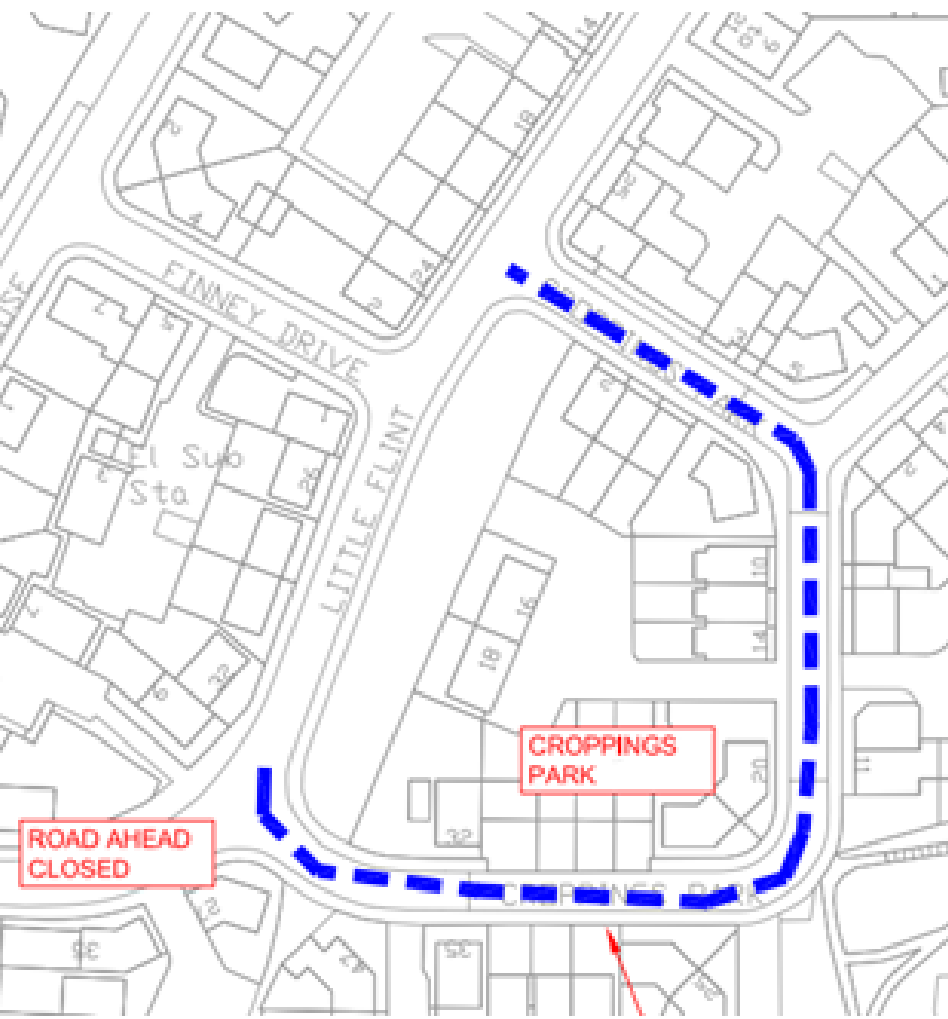

**Contractor completes all
works to footways at Furnace
Lane – other civils works by
Stoney Hill also being
completed**

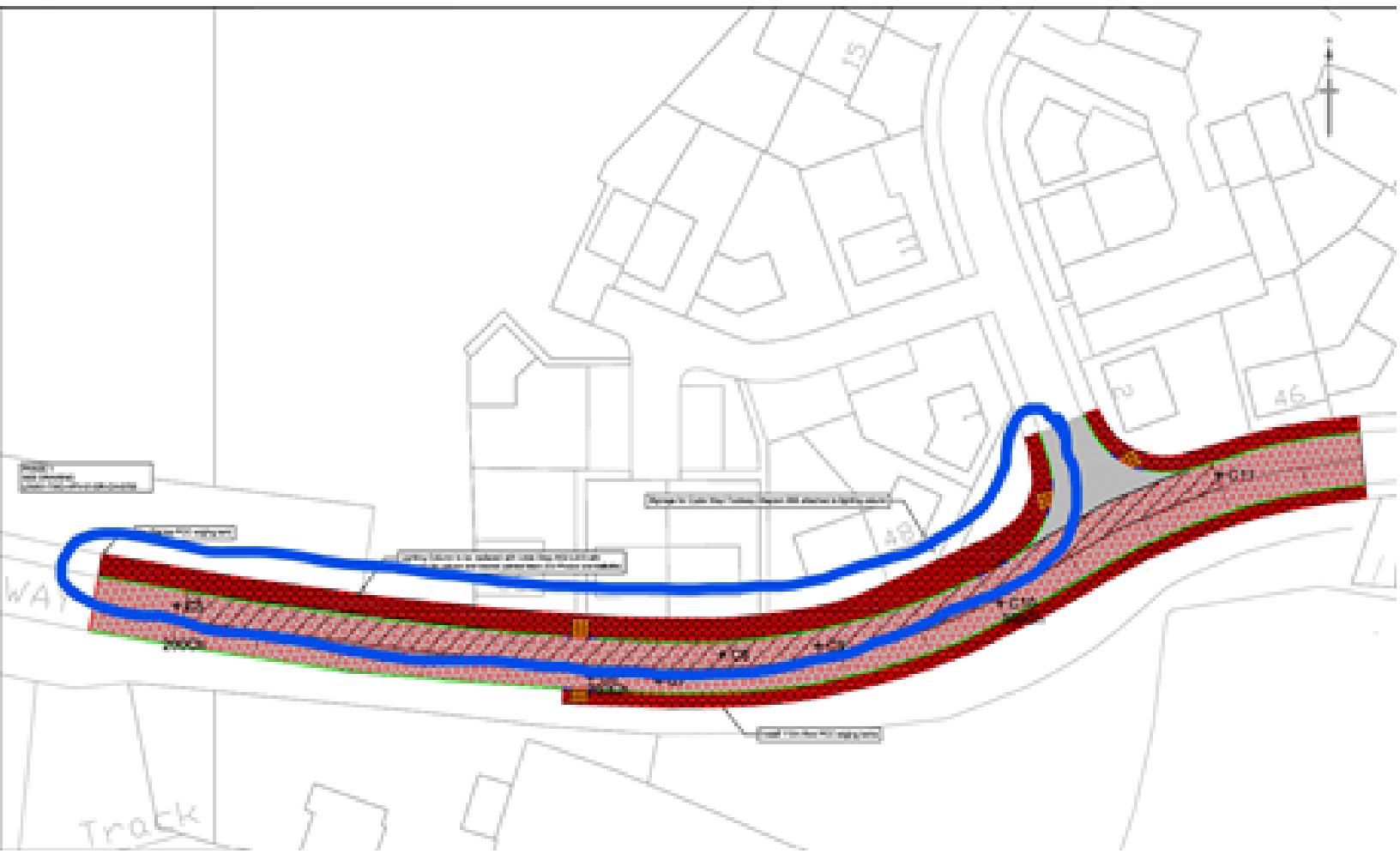

Phase 2

Reduced closure extents as below
with two-way traffic lights on
Furnace Avenue Junction (if
required)

Mon 20th – Fri 24th October

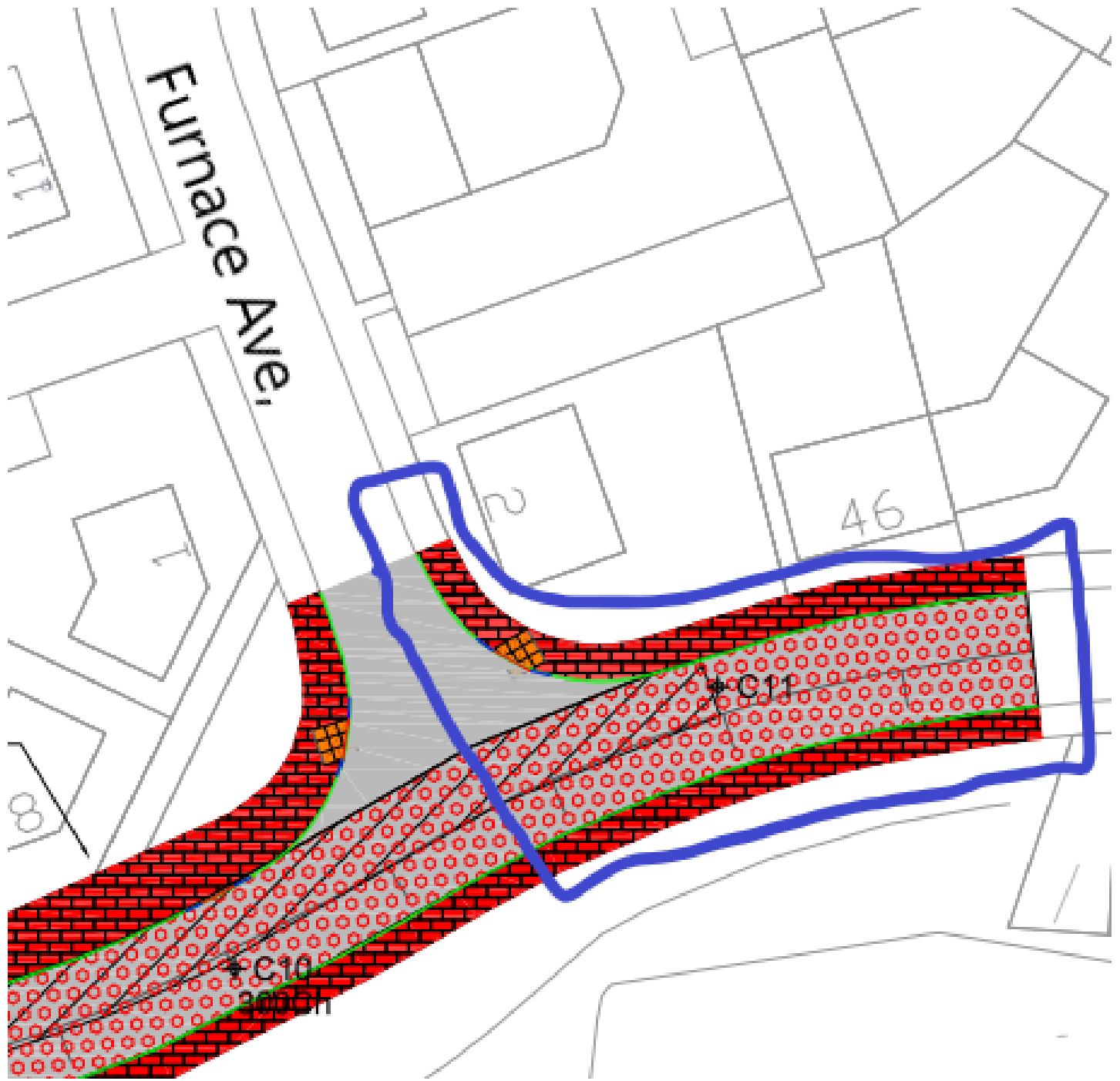

Footways Works to all be
completed to finished levels in this
area

Footway surfacing on Wellington
Road on two way lights

Bus diversion via Croppings Park
with on street parking suspended

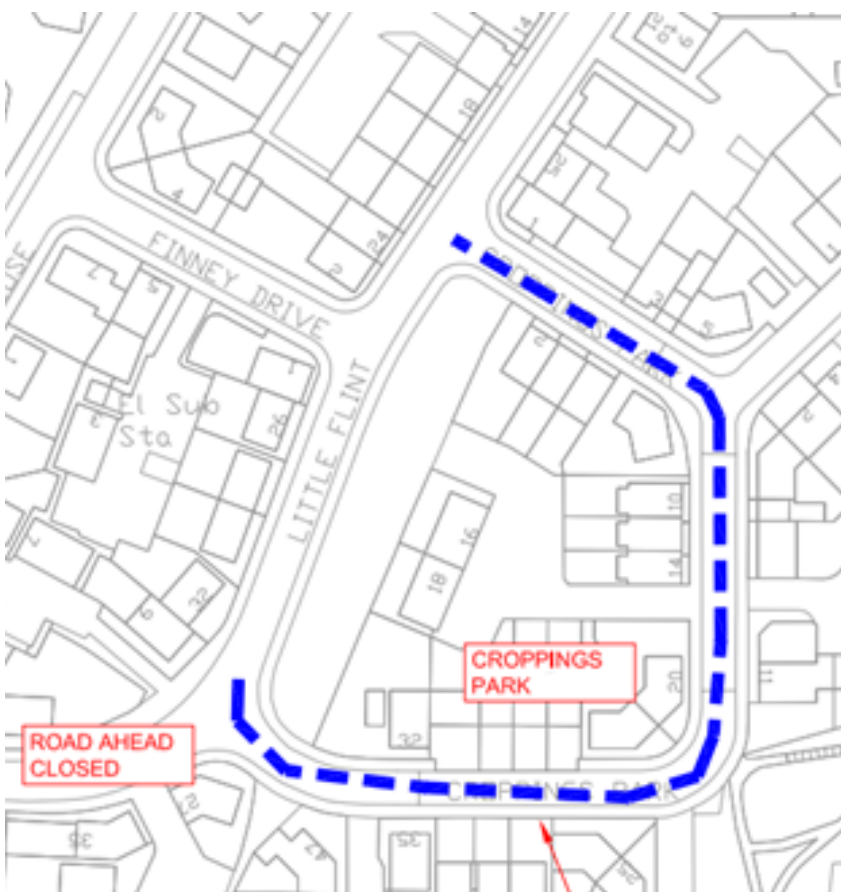

Phase 3

Closure extents reduced to Furnace Lane 27th October – 12th December

Footways Works to all be
completed in both of the
Lightmoor Way South sections to
finished levels in this area

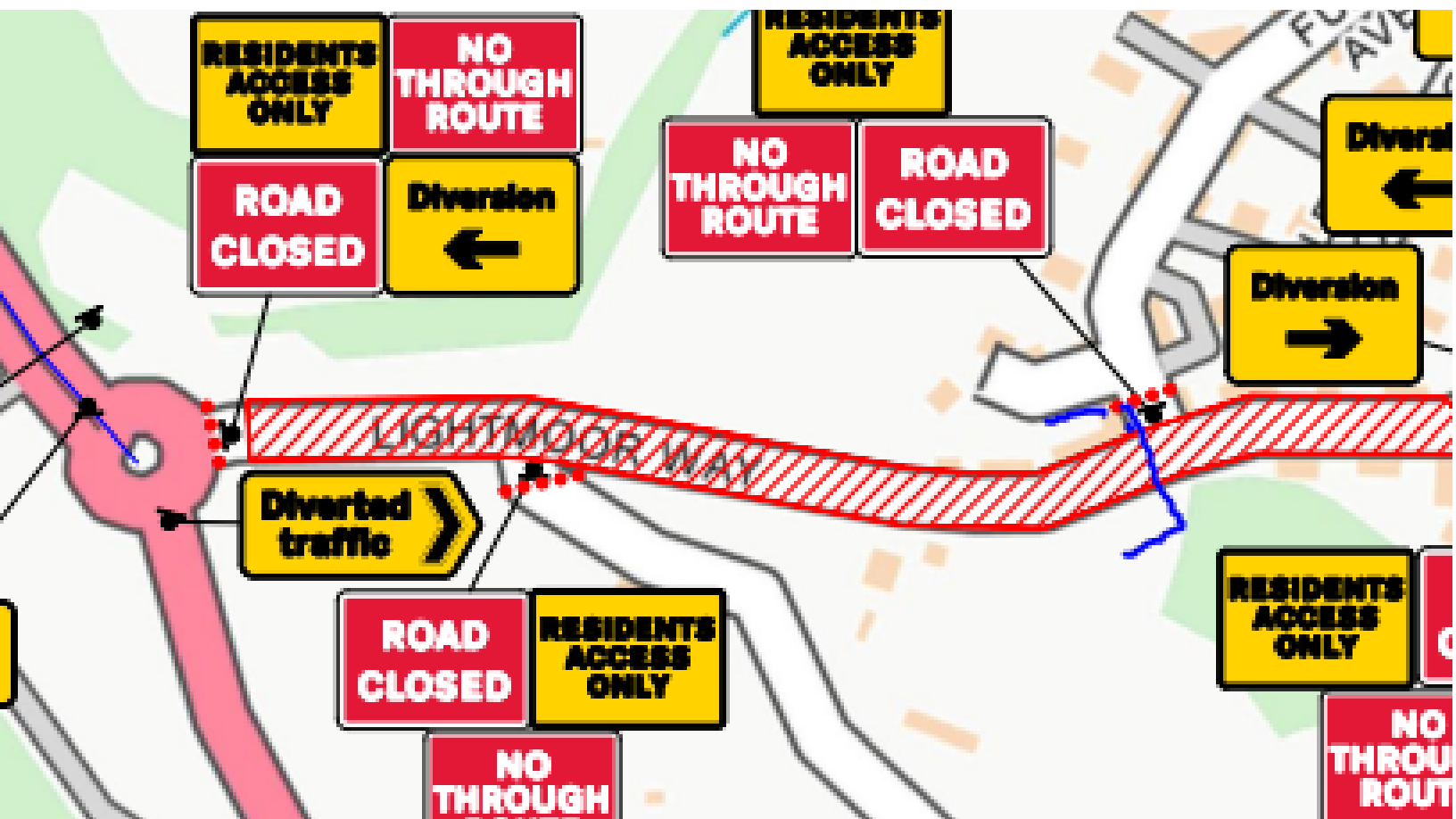

Bus diversion via Croppings Park with on street parking suspended

